

Using disposable respirators

Pre-use checks

- You should be clean-shaven around the face seal to achieve an effective fit when using disposable respirators. Beards and stubble will stop the disposable respirator sealing to your face and protecting you properly
- Make sure it is the right disposable respirator for your work and for you - have you passed a face fit test in this disposable respirator?
- Make sure the disposable respirator is clean and undamaged before you use it
- Follow the manufacturer's instructions for checking the disposable respirator and putting it on
- Check the fit every time you put on the disposable respirator to ensure there are no leaks

Putting the disposable respirator on and checking it fits

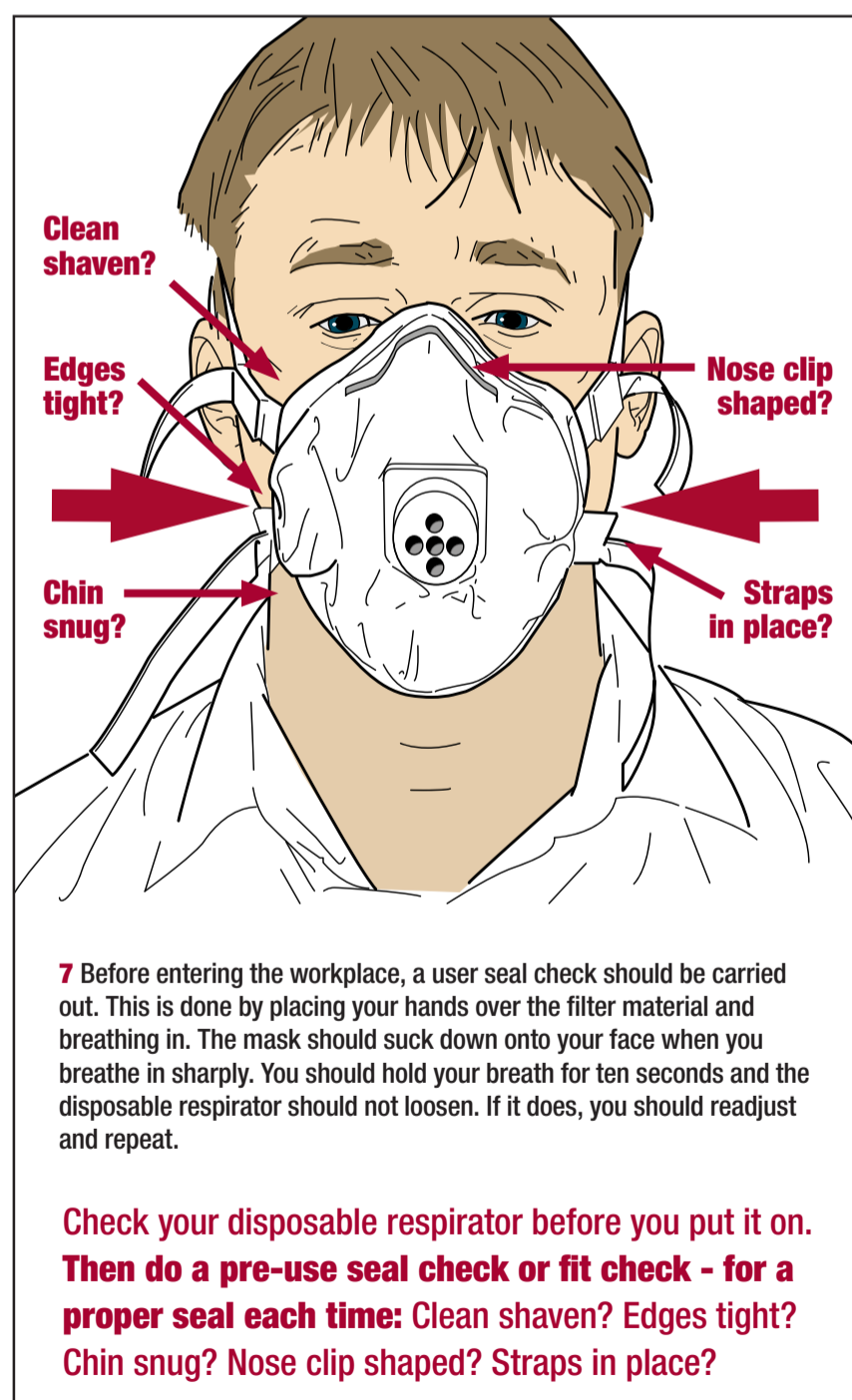
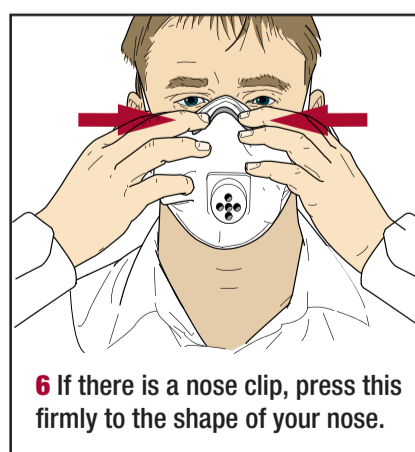
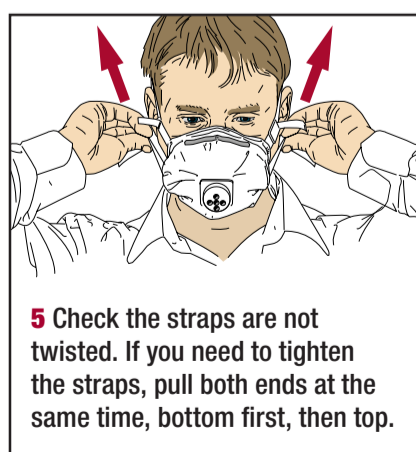
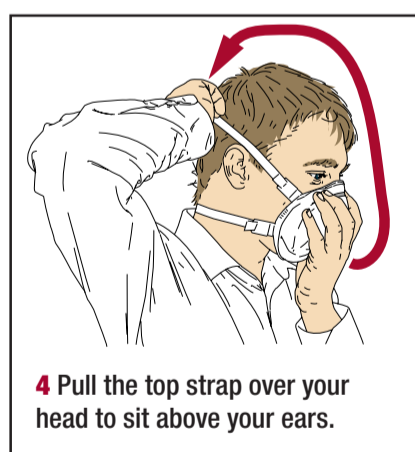
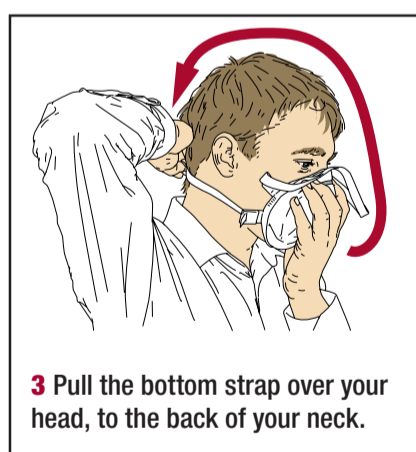
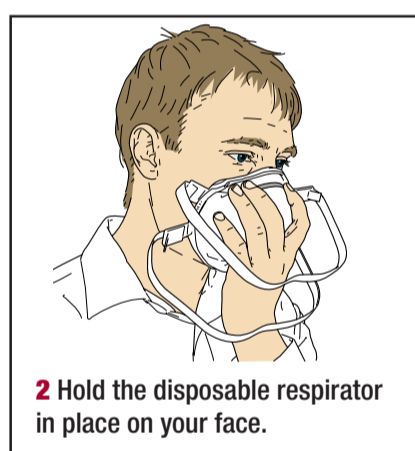
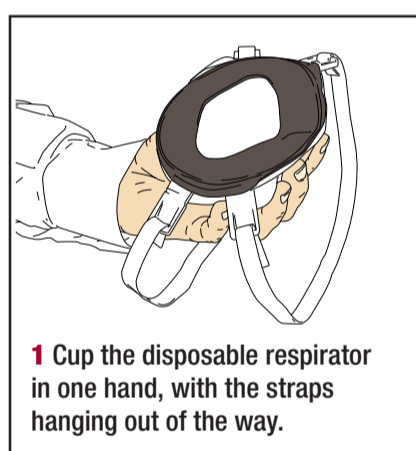

This poster illustrates a typical disposable respirator, there are many other types available. Follow the manufacturer's instructions on putting your type of disposable respirator on and checking it fits.

Visit [hse.gov.uk/respiratory-protective-equipment](https://www.hse.gov.uk/respiratory-protective-equipment) for more information